



SELF-PRIMING CAENTRIFUGAL PUMP

SERIES 'T'

EXPLODED VIEW PARTS DIAGRAM

PARTS LIST
P-9920E
SEPT. 1994

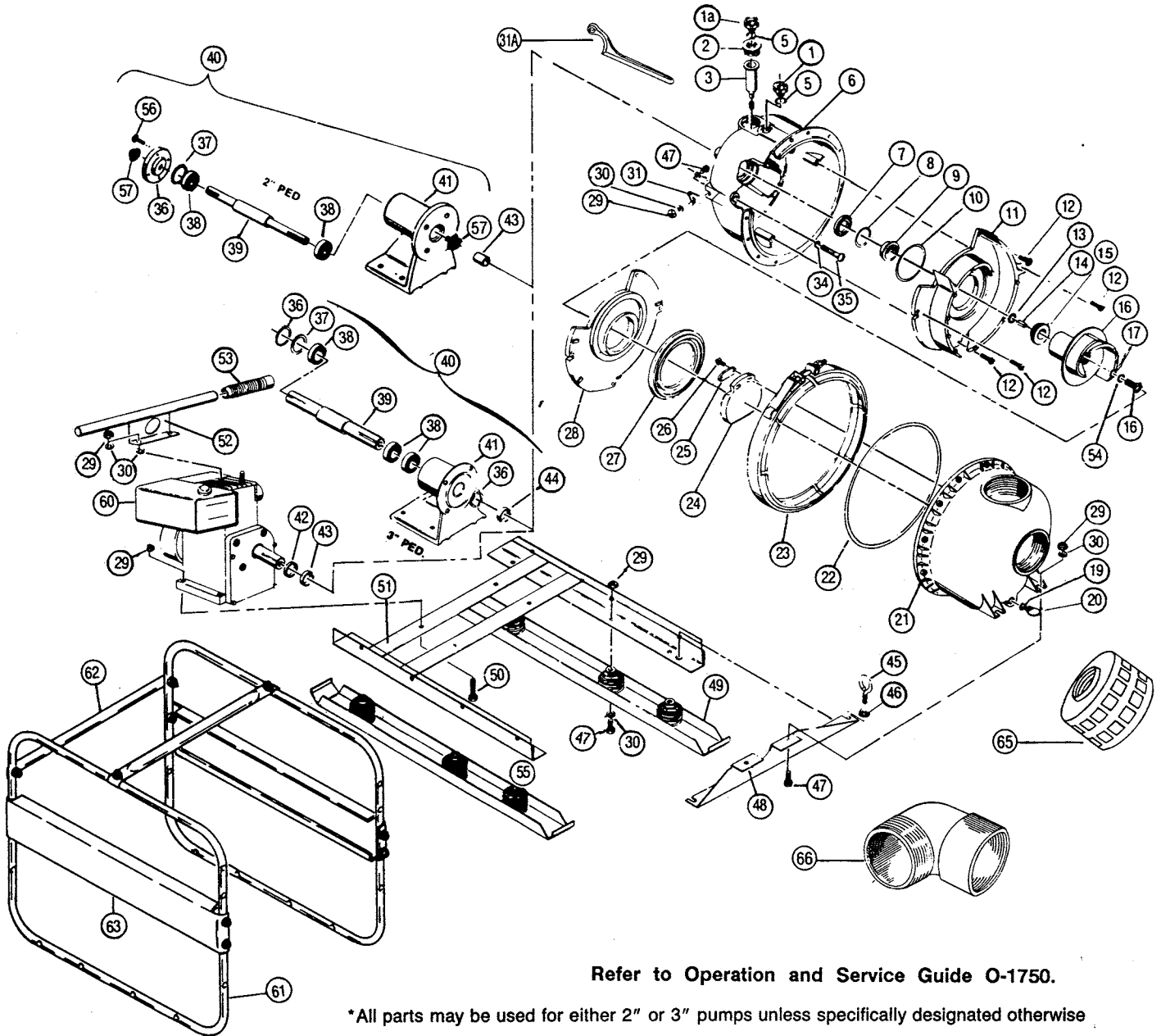

Refer to Operation and Service Guide O-1750.

*All parts may be used for either 2" or 3" pumps unless specifically designated otherwise

ITEM NO.	*PUMP SIZE	PART NO.	DESCRIPTION	QUANTITY PER PUMP
1		64-0722 30B	PLUG, filler, black polyester	1
1A		64-0722 30B	PLUG, filler, oil lube, black polyester	1
2		64-46294 30	RETAINER, lube tube	1
3		64-46215 71	TUBE, lubrication, buna-N	1
5		64-0765 71	O-RING, filler plug, buna-N	2
6	.2"	64-46218 31B	BRACKET, assembly, includes items 1, 1A, 2,3,5,6,7,8,9	1
	.3"	64-46208 31B	BRACKET, assembly, includes items 1, 1A, 2,3,5,6,7,8,9	1
7	.2"	64-46314 11	SEAL, oil lip	1
	.3"	64-46313 11	SEAL, oil lip	1
8	.2"	64-0976 71	O-RING, shaft seal, buna-N	1
	.3"	64-46307 71	O-RING, shaft seal, buna-N	1
9 & 15	.2"	64-46250 11	SEAL, shaft, stainless steel/siliconized graphite/buna-N	1
	.3"	64-46251 11	SEAL, shaft, stainless steel/siliconized graphite/buna-N	1
10	.2"	64-1203 71	O-RING, volute, buna-N	1
	.3"	64-46292 71	O-RING, volute, buna-N	1
11	.2"	64-46224 80	VOLUTE, urethane coated with steel core	1
	.3"	64-46204 80	VOLUTE, urethane coated with steel core	1
11	.2"	64-46224 90		1
	.3"	64-46204 90		1

ITEM NO.	*PUMP SIZE	PART NO.	DESCRIPTION	QUANTITY PER PUMP
12	.2"	64-46269 10	.SCREW, Btn. Hd. 1/4"-20x1", stainless steel	2
	.3"	64-46269 10	.SCREW, Btn. Hd. 1/4"-20x1", stainless steel	4
13	.2"	64-0778 11	.SHIM, impeller, .006" thick, stainless steel	As needed
	.2"	64-0778 12	.SHIM, impeller, .015" thick, stainless steel	As needed
	.2"	64-0778 13	.SHIM, impeller, .030" thick, stainless steel	As needed
	.3"	64-46338 10	.SHIM, impeller, .015" thick, stainless steel	As needed
14	.2"	64-46339	.KEY, 3/16" square x 11/16" long, steel	1
	.3"	64-46278	.KEY, 1/4" square x 1" long, steel	1
16	.2"	64-46229 80	.IMPELLER, urethane coated with steel core	1
	.2"	64-46229 81	.IMPELLER, same as above but with siliconized graphite seal half installed	1
16	.2"	64-46229 90	.IMPELLER, molded, POLYMAR 656	1
	.2"	64-46229 91	.IMPELLER ASSY, molded, POLYMAR 656 with siliconized graphite seal half	1
	.3"	64-46214 80	.IMPELLER, urethane coated with steel core	1
	.3"	64-46214 81	.IMPELLER, same as above but with siliconized graphite seal half installed	1
16	.3"	64-46214 90	.IMPELLER, molded, POLYMAR 656	1
16	.3"	64-46214 91	.IMPELLER ASSY, molded, POLYMAR 656 with siliconized graphite seal half	1
17	.2"	64-46291 71	.O-RING, impeller screw, buna-N	1
	.3"	64-46290 71	.O-RING, impeller screw, buna-N	1
18	.2"	64-0715 10	.SCREW, impeller, 5/16"-24x1-1/4" stainless steel	1
	.3"	64-46309 10	.SCREW, impeller, 7/16"-20x1-1/4", stainless steel	1
19		64-1009 71	.O-RING, drain plug, buna-N	1
20		64-0723 30	.PLUG, drain, polyester	1
21	.2"	64-56252 31B	.BODY, assembly, includes items 19,20,24,25,26,27, and the body (front housing)	1
	.3"	64-46207 31B	.BODY, assembly, includes items 19,20,24,25,26,27, and the body (front housing)	1
22		64-46304 71	.O-RING, body, buna-N	1
23		64-46305 10	.CLAMP, V-band, stainless steel	1
24		64-46217 71	.VALVE, check, buna-N	1
25		64-46344 30	.RETAINER, check valve, polyester	1
26		64-1348 10	.SCREW, check valve retainer, #10-14x3/4", self-tapping, stainless steel	2
27		64-46206 71	.GASKET, suction, buna-N	1
28	.2"	64-46225 91	.WEARPLATE, rubber coated with steel core	1
	.3"	64-46205 91	.WEARPLATE, rubber coated with steel core	1
28	.2"	64-46225 95		1
	.3"	64-46205 95		1
29	.2" & 3"	64-0745	.NUT, keps, 5/16"-18, plated steel	As needed
30		64-0730	.WASHER, flat, 5/16", plated steel, Engine drive only	14
31		64-46274	.HOLDER, spanner wrench, steel	1
31A	.2"	64-1896 50	.WRENCH, spanner, 2" pump engine drive only	1
	.3"	64-1897 50	.WRENCH, spanner, 3" pump engine drive only	1
32		64-0729	.SCREW, wrench holder, 5/16"-18x1", plated steel	1
34	.2"	64-0717 71	.O-RING, bracket screw, buna-N	4
	.3"	64-46303 71	.O-RING, bracket screw, buna-N	4
35	.2"	64-0715 10	.SCREW, bracket, 5/16"-18x1-1/4" stainless steel/engine drive/ped. mount	4
	.3"	64-46308 10	.SCREW, bracket, 3/8"-16x1-3/4", stainless steel, engine drive/ped. mount	4
36	.2"	64-1953 10	.END PLATE, stainless steel	1
	.3"	64-46354	.RING, snap, retaining, steel	2
37	.2"	64-1956 10	.SHIM, stainless steel	As needed
	.3"	64-46353 10	.SHIM, stainless steel	As needed
38	.2"	64-1954 90	.BEARING	2
	.3"	64-46352 90	.BEARING, 1652 for 58-46350 02 ped assy.	3
38	.3"	64-46372 90	.BEARING, 6206, for 58-46350 03 ped assy.	3
39	.2"	64-1952 10	.SHAFT 3/4" diameter, stainless steel	1
	.3"	64-46346 10	.SHAFT, 1"x1-1/8" diameter, stainless steel, for 58-46350 02 ped assy.	1
39	.3"	64-46371 10	.SHAFT, 1" x 1-1/8" diameter, stainless steel, for 58-46350 03 ped. assy.	1
40	.2"	64-1950 03	.PEDESTAL ASSEMBLY, includes items 36,37,38,39,41,43,56, & 57 (3/4" shaft)	1
	.3"	64-46350 02	.PEDESTAL ASSEMBLY, includes items 36,37,38,39,41, & 44 (1" shaft)	1
40	.3"	64-46350 03	.PEDESTAL ASSEMBLY, includes items 36,37,38,39,41,44 (1" shaft)	1
41	.2"	64-1951 90	.HOUSING, bearing pedestal for 3/4" shaft	1
	.3"	64-46345 90	.HOUSING, bearing pedestal, for 58-46350 02 ped. assy.	1
41	.3"	64-46373 90	.HOUSING, bearing pedestal, for 58-46350 03 ped. assy.	1
42	.2"	64-0884 71	.SLINGER, buna-N, for 3/4" shaft	1
	.3"	64-46266 71	.SLINGER, buna-N, for 1" shaft	1
43	.2"	64-46219 10	.SLEEVE, for 3/4" shaft, stainless steel	1
44	.3"	64-46359 10	.SLEEVE, for 1" shaft, stainless steel	1
45 & 46		64-46282 01	.BOLT, eye, and nut assembly, plated steel	2
47		64-0729	.SCREW, 5/16"-18x1", plated steel	8
48	.2"	64-46306	.SUPPORT, front housing, 17" long, painted steel	1
	.3"	64-46365	.SUPPORT, front housing, 19-15/16" long, painted steel	1
48	.3"	64-46363	.SUPPORT, front housing 19-15/16" long, for pump cc to 9 hp Vanguard Briggs & Stratton Engine, painted steel	1
49	.3"	64-46331 01	.SKID ASSEMBLY, includes mounted springs	2
	.2"	64-46315 01	.SKID ASSEMBLY, includes mounted springs	2
50		64-2167	.SCREW, chassis & roll cage mounting, 5/16"-18x1-1/2", plated steel	As needed

(continued)

DIAGRAM OF ECONOMY "T" PUMP

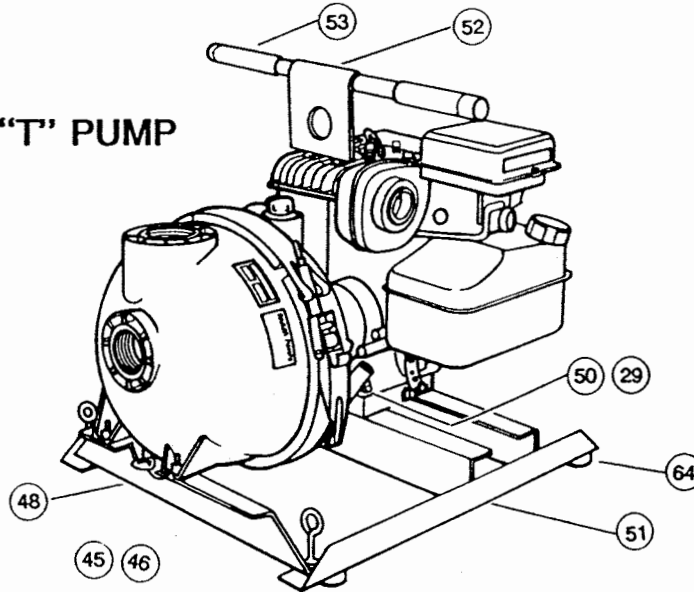

ITEM NO.	*PUMP SIZE	PART NO.	DESCRIPTION	QUANTITY PER PUMP
51	.2"	64-46310	.CHASSIS, weldment, painted steel	1
	.3"	64-46335	.CHASSIS, weldment, painted steel	1
52	.3"	64-46268	.HANDLE, weldment, painted steel	1
52	.2"	64-46311	.HANDLE, weldment, 17-1/2" long, painted steel	1
53		64-46267 90	.GRIP, handle, vinyl	2
54	.2" Only	64-46341	.WASHER, impeller screw, rubber coated	1
55		64-46317	.SPRING, plated steel	6
56	.2"	64-2525 10	.SCREW, hex, 1/4"-20x3/4", stainless steel	4
57	.2"	64-1955 71	.LIP SEAL, buna-N	2
60	.2"	64-0635	.ENGINE, B&S, 5 hp standard, recoil start, econo 'T' only	1
60	.2"	64-0635 A	.ENGINE, B&S, 5HP, 1/C Recoil Start	1
	.3"	64-0648 A	.ENGINE, B&S, 8HP, 1/C Recoil Start	1
60	.3"	64-0648 V	.ENGINE, B&S, 9 hp-Vanguard overhead valve, recoil start	1
61		64-46261 10	.ROLL CAGE SIDE FRAME, stainless steel	2
62		64-46265 10	.ROLL CAGE BRACE BARS, stainless steel	2
63		64-46312	.ROLL CAGE SIDE PLATE, painted steel	2
64		64-0114	.RUBBER FEET KIT	1
65	.2"	64-46286	.2" STRAINER, zinc pltd steel, engine drive only	1
	.3"	64-46287	.3" STRAINER, zinc pltd steel, engine drive only	1
	.2"	64-0733	.2" STRAINER, polyethylene, engine drive only	1
	.3"	64-0757	.3" STRAINER, polyethylene, engine drive only	1
66	.2"	64-0752 40	.2" STREET ELBOW, polypropylene	1
	.3"	64-0756 40	.3" STREET ELBOW, polypropylene	1

Quantity per pump is based upon an engine driven pump mounted on spring isolated base rails. Other models may require fewer of certain incidental parts such as screws, washers, etc.

