

# SERIES 'B' METERING PUMP B71, B72, B73, B74

PARTS LIST  
P-8300B  
MARCH 1992

Refer to Operation and Service Guide O-940.

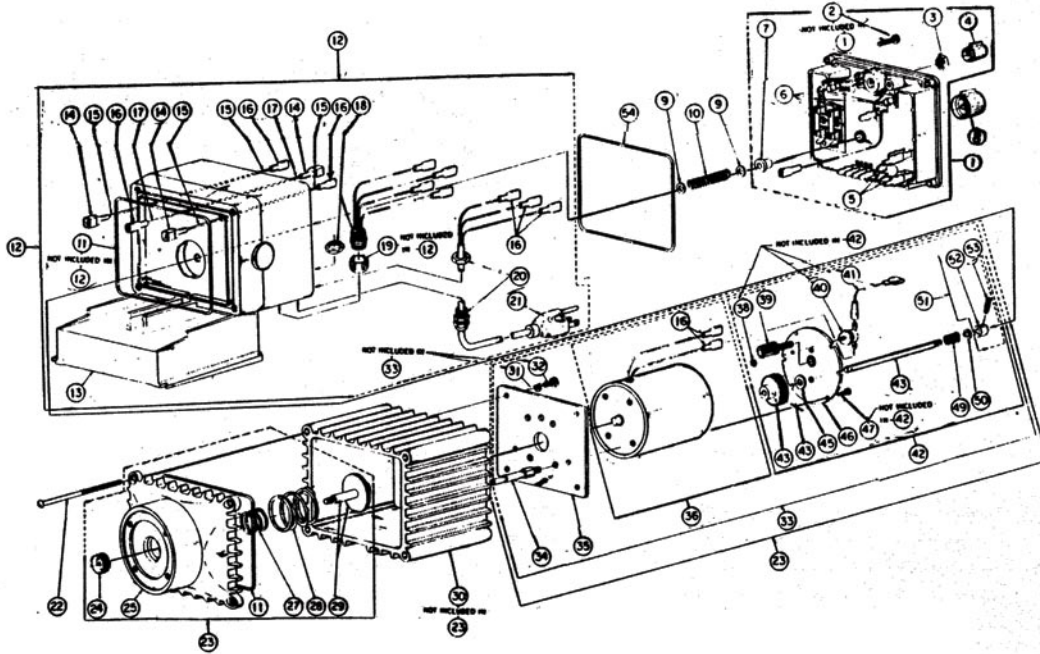

ITEM NO.	DESCRIPTION	MODEL B71 PART NO.	MODEL B72 PART NO.	MODEL B73 PART NO.	MODEL B74 PART NO.
1	Control panel - 115/1/60 -230/1/50-60	25-0911 25-0913	25-0912 25-0914	25-0912 25-0914	25-0912 25-0914
2	Screw, 10-24x1" pan head stainless steel (4 req'd)			25-0866	
3	Shaft seal			25-0968	
4	Knob			25-0899	
5	Varistor assembly - 130V - 220-240V			10-0626 10-0627	
6	Fuse - 4A Rectifier - 115/1/60 (4 req'd) -2A " - 230/1/50-60 (4 req'd)			25-0825 25-0824	
7	Bushing			25-0849	
8	Knob			25-0891	
11	"O"-ring (2 req'd)			10-0366	
12	Housing assembly - 115/1/60 - 230/1/60 - 220-240/1/50			25-0908 25-0909 25-0910	
13	Housing, less wires			25-0161-6	
15	Wire, yellow (2 req'd)			10-0488-48	
18	Jack assembly			25-0907	
19	Plastic cap			25-0930	
20	Ferrule nut - 115-230/1/60 - 230/1/50			25-0957 25-0957-1	
21	Power cord - 115/1/60 - 230/1/60 - 220-240 DIN plug /1/50			10-0178 10-0384 10-0382	
22	Screw, round head slotted, stainless steel			25-0127	
23	Solenoid & spacer assembly - 115/1/60 - 230/1/50-60	25-0426 25-0427	25-0426 25-0427	25-0429 25-0430	25-0429 25-0430
24	Seal			10-0973	
30	Sleeve, solenoid			25-0068	
31	Washer, fan disk (4req'd)			10-0415	
32	Screw (4 req'd)			10-0168	
42	Stroke adjustment assembly			25-0328	
54	"O"-ring			10-0166	
57	EPU and spacer assembly w/stroke adjustment				

# LIQUID HANDLING ASSEMBLIES MODELS: B11, B12 & B71, B72

Use Teflon tape only at this point.

1. Maximum pump pressure rating is reduced by 25 psi (1.7 bar) with anti-syphon spring installed.
2. Do not remove anti-syphon spring if pressure at injection point is less than 20 psi (1.4 bar).

ITEM NO.	DESCRIPTION	PART NUMBERS	
		PVC	Polypropylene
2*	Spring		10-0339
3	Ball, ceramic (4 req'd)		10-0330
4	Seal ring, TFE (4 req'd)		10-0407
5	Valve seat, PVC (2 req'd) Ivory, polypropylene (2 req'd)		10-0292 10-0392
6	Coupling nut (4 req'd)		10-0299
7	Tubing, polyethylene, .375" O.D.		10-0342-16
8	Valve housing, PVC Ivory polypropylene (2 req'd)		10-0293 10-0393
9	Screw, 10-24 x 3/4" S.S. (4 req'd)		10-0340
10*	Diaphragm, 0.9 SI, TFE		10-0302
11	Head 0.9 SI, PVC Ivory, polypropylene	10-0213 -	- 10-0313M
12	Weight, ceramic	10-0322	10-0322
13	Foot valve seat	10-0978	10-0978
14	Strainer, polypropylene	10-0123	10-0123
15	Injection check/back pressure valve ASM	25-0233	25-0073
16	Discharge valve assembly	25-0231	25-0074
17	Suction valve assembly	25-0232	25-0075
18	Foot valve assembly	25-0234	25-0076
19	Head assembly, LE-92T LE-95T	25-0230 -	- 25-0077
26	Flapper valve	27-0352	-
27	Injector fitting	26-0841	10-0394

