



SERIES 'TM' CENTRIFUGAL MAGNETIC COUPLED PUMPS



**ENGINEERED FOR SUPERIOR LONG
TERM RELIABILITY IN DEMANDING
APPLICATIONS:**

***CHEMICAL / PRINTED CIRCUIT
SEMI-CONDUCTOR / ELECTROPLATING
METAL FINISHING / PHOTO PROCESSING
WATER and WASTE TREATMENT***

- **Flows to 130 GPM or 68 ft. TDH @ 60 Hz**
(409 LPM or 14.4m @ 50 Hz)
- **Non-metallic solution contact**
Polypropylene or PVDF pump
Choice of EPDM or Viton® elastomers
(See a chemical resistance chart)
- **High torque magnets**
To 1.5 S.G. with standard models
- **Massive thrust bearings**
- **Heavy walled voluted casings for higher
temperature applications**
- **Centrifugal, quiet, vibration-free**
- **Seal-less, leak-free magnetic coupled**
- **For use with standard NEMA or IEC
'C'-face motors**

The Series 'TM' magnetic coupled centrifugal pump directly addresses the weaknesses of other magnetic drive pumps. From high torque compact magnets to a large diameter reduced length shaft to massive precision finished thrust bearings, the 'TM' pump is designed to excel where other pumps

fail. Heavy walled voluted casings improve pump strength, internal shaft support, chemical resistance, pressure and temperature capabilities as well as hydraulic efficiencies. Standard models are non-overloading with stated elevated specific gravity liquids.

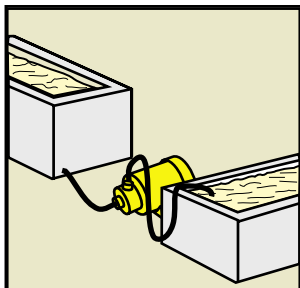

WASTE TREATMENT

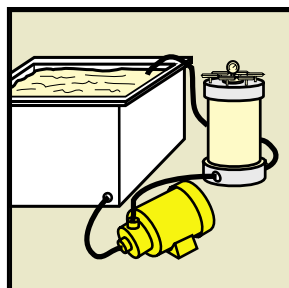

FILTRATION

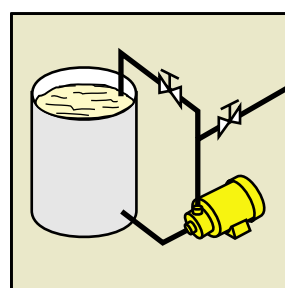

TRANSFER PUMPING

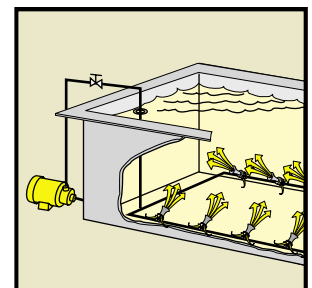

EDUCTOR AGITATION
and MIXING

SERIES 'TM' PUMPS Specifications and ordering information

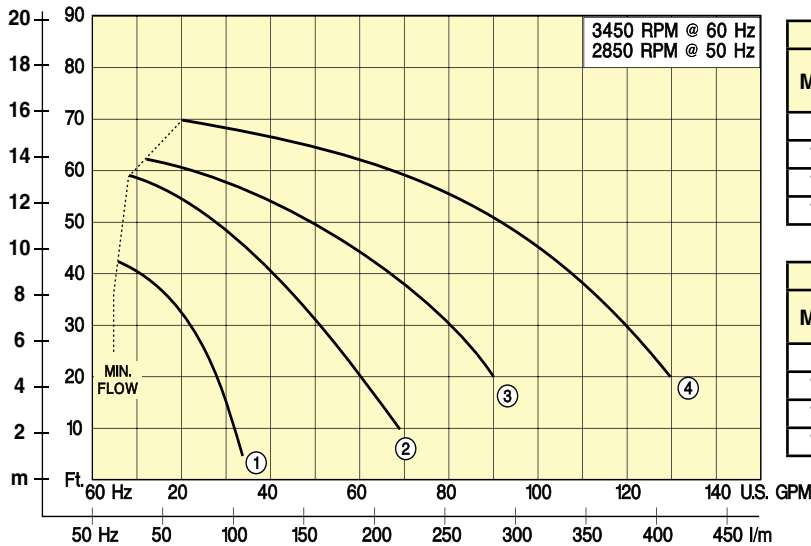

DIMENSIONS Inches					
MODEL	NEMA FRAME	A	B	C	D
TM6	56C	2-5/16	6-3/4	5-5/8	3-9/16
TM10		2-3/4	7-15/16	6-1/8	3-15/16
TM15		3-1/4	9-3/4	7-7/8	4-7/8
TM30	145TC	3-5/8	11	7-1/2	4-1/4

DIMENSIONS Inches					
MODEL	NEMA FRAME	E	F	G	H
TM6	56C	3-1/2	7-1/16	1-13/16	6-1/2
TM10		3-1/2	7-7/16	1-3/4	6-1/2
TM15		3-1/2	8-3/8	2-1/2	6-1/2
TM30	145TC	3-1/2	--	2-1/2	--

NOTE: Motor dimensions may vary.

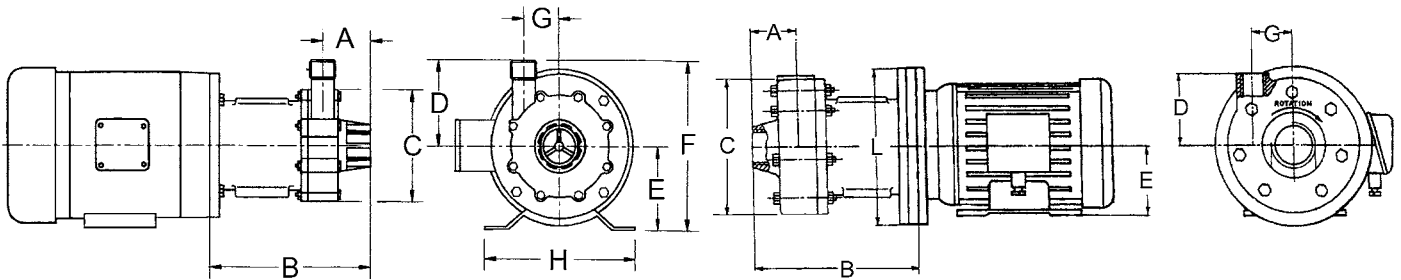

MODELS TM6, TM10 and TM15

MODEL TM30

Series 'TM' Polypropylene / EPDM: Polypropylene casing, impeller magnet enclosure, carbon fiber reinforced polypropylene rear casing, silica-free ceramic shaft and stationary thrust bushings, carbon filled PTFE rotating sleeve and bushings, EPDM 'O'-ring. *To order, use Price Code No. below. (Maximum operating temperature 150°F Maximum operating pressure 110 psi)*

FLOW CURVE	MAX. FLOW ¹		MAX. TDH ²		MAX. S. G. ³	HP	IMPELLER DIA.	CONNECTIONS SUCT. x DISCH.	MODEL NO.	PRICE CODE NO.	SHIPPING WT. (lbs.)
	GPM	LPM	ft.	m							
1	34	107	42	8.9	1.5	.75	3.2"	1" FNPT x 3/4" MNPT	TM6-3.2 D.75	51-0100	31
2	67	211	58	12.3	1.4	1.5	3.85"	1 1/2" FNPT x 1" MNPT	TM10-3.85 D1.5	51-0101	42
3	90	283	64	13.5	1.4	2.0	3.9"	1 1/2" FNPT x 1 1/4" MNPT	TM15-3.9 D2.0	51-0102	56
4	130	409	68	14.4	1.4	3.0	4.0"	2" FNPT x 1 1/2" MNPT	TM30-4.0 D3.0	51-0103	64

Series 'TM' PVDF / Viton: Same construction as polypropylene except PVDF casing, impeller, internal magnet enclosure, rear casing and Viton 'O'-ring. *To order PVDF / Viton pump, add -K to Model No. and Price Code No. (Maximum operating temperature 190°F. Maximum operating pressure 110 psi)*

TO ORDER —

EPDM, add **-L** to Model No. and Price Code No.
Viton, add **-V** to Model No. and Price Code No.

Motors are TEFC, 230 - 460V / 3 / 60 Hz.
To order 115 - 230V / 1 / 60, change **D** to **C** in Model No. and add **-1** to Price Code No.

Consult sales department for 50 Hz motors.

¹ GPM @ 60 Hz, LPM @ 50 Hz

² ft. TDH @ 60 Hz, m TDH @ 50 Hz

³ Motors are non-overloading at stated specific gravity.



SERFILCO

2900 MacArthur Blvd. 847-509-2900
Northbrook, IL 60062-2005 U.S.A. 800-323-5431
e-mail: sales@serfilco.com FAX: 847-559-1995
www.serfilco.com