

SERFILCO®

SELF-PRIMING PUMP & MOTOR UNITS

MODEL 3/4 JPSV

PARTS LIST

P-3000D

3-24-95 Mar., 1979

F.Y.I.

OBSOLETE JULY '92

SUPERCEDED BY

P-2050G JULY '92

ACC

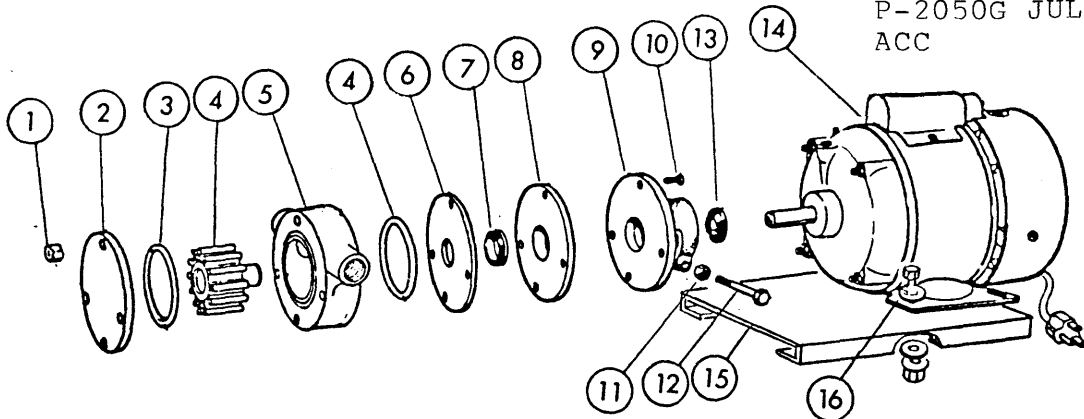

Refer to Master Price List F-800

| DESCRIPTION | PART NUMBER |
|--|----------------------------|
| *1. Nut | 11-292 |
| 2. End cover | 44-259 |
| *3. Impeller & shaft (Neoprene) | 44-244 |
| *4. "O" ring (Neoprene) | 44-227 |
| 5. Body | 44-255 |
| 6. Wear Plate | 44-247 |
| *7. Shaft seal | 44-240 |
| *8. Seal liner | 44-226 |
| 9. Adaptor | 44-256 |
| 10. Bolt | 11-290 |
| 11. Nut | 11-293 |
| 12. Bolt | 11-291 |
| 13. Slinger | 44-260 |
| 14. 1/2 H.P., T.E.F.C. motor, 115/1/60, w/line cord | 44-229 |
| 15. 9" x 13" base, vinyl coated steel | 77-103-1 |
| 16. 1/4-20 hex head bolt (4 req'd) 1/4" flat washer (8 req'd) 1/4" wizz lock nut (4 req'd) | 11-133 11-121 11-103 |
| 3/4" I.D. x 10 ft. clear vinyl reinforced hose (2 req'd) (not shown) | 22-620 |
| 1/2" pipe to 3/4" hose adaptor (2 req'd) (not shown) | 33-246 |
| Hose clamps (2 req'd) (not shown) | 22-505 |
| Pump assembly w/out motor & base | 44-228 |

*Recommended spare part.

(We suggest you order the recommended spare parts which will be required for pump servicing, and group your orders whenever possible to minimize handling and processing costs, in an effort to keep your cost of operation as low as possible.)

F.O.B. Northbrook, Illinois

Terms: Net 30 Days

Minimum order \$25.00



SERFILCO®, LTD.

1777 Shermer Road Northbrook, IL 60062-5360 U.S.A. Telex: 289557 SERFC UR

708-559-1777 800-323-5431 FAX: 708-559-1995

DISTRIBUTED BY

EASTERN

One Lark Avenue Leola, PA 17540 FAX: 717-656-0477 Telex: 285564 ASM UR

WESTERN

5005 S. Hampton Street Los Angeles, CA 90058 FAX: 213-588-0801 FAX: 213-588-6826