

# PLASTIC PISTON PUMPS

MODEL	PRICE CODE NO.
B	56-0003

Refer to Bulletin P-404.

## SAFETY PRECAUTIONS

1. Read operating instructions and instructions supplied with chemicals to be used.
2. Refer to a chemical resistance data chart for compatibility of materials in pump with solution to be used.
3. Note temperature and pressure limitations.
4. Personnel operating pump should always wear suitable protective clothing: face mask or goggles, apron and gloves.

## BEFORE CHANGING APPLICATION OR PERFORMING MAINTENANCE

1. Wear protective clothing as described in item 4 above.
2. Flush pump thoroughly with a neutralizing solution to prevent possible harm to personnel.
3. Verify compatibility of materials as stated in item 2 of Safety Precautions above.

**NOTE:** Acceptable chemical resistance is not an implied recommendation of use. Safe handling of chemicals to prevent spillage, damage to equipment, and explosion or personal injury must be avoided and is the responsibility of the user.

Before using any kind of pump, make sure you fully understand the nature of the fluid to be dispensed, i.e., nonvolatile, volatile, hazardous, caustic, etc. Follow precautions on this instruction sheet and product container label.

The pump is constructed of polypropylene and polyethylene. It discharges on the upstroke.

1. A. Spigot is permanently attached for use. Do not pull or twist spigot.  
B. Do not hang containers and other objects from the end of the spigot because they may pull the spigot off the pump head.  
C. Make certain spigot is positioned as in drawing; with liquid exiting downward.
2. Join lengths of extension tubing with tube connectors and clamps.
3. Attach extension tubing to bottom of pump and secure with clamp.
4. Insert pump in either 3/4" or 2" drum opening and hand tighten.

5. Adjust pump delivery by use of snap-on adapters to pump piston rod.  
8 oz. delivery No adapter  
6 oz. delivery Use short adapter  
4 oz. delivery Use large adapter  
2 oz. delivery Use short & large adapter
6. Remove spout cap from spigot before use. Replace cap when not in use to prevent foreign material from entering pump and to retard evaporation.
7. For 15 or 30 gallon drums, extension tubing may be cut off to fit.
8. Entire pump head may be rotated to any desired position.  
Person operating pump should stand to the side or in back of the spigot.
9. Packing nut at shaft may be tightened when required to prevent leakage. Tighten only until seepage stops.

**WARNING:** This pump is not to be used for handling flammable or combustible liquids.

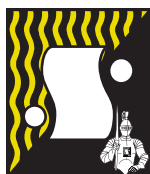
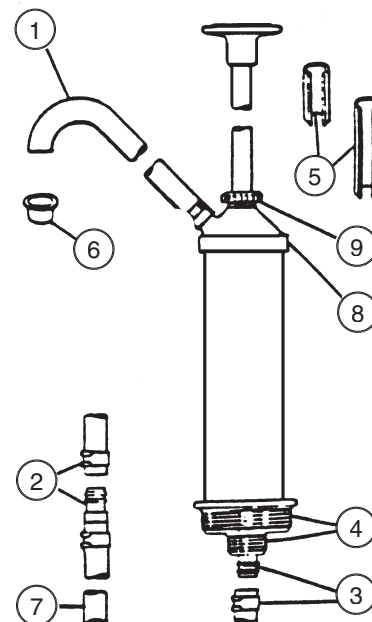

## SERFILCO<sup>®</sup>, LTD.

2900 MacArthur Blvd. 847-509-2900  
Northbrook, IL 60062-2005 U.S.A. 800-323-5431  
e-mail: sales@serfilco.com FAX: 847-559-1995  
www.serfilco.com