

SPECIAL FILTER SYSTEMS

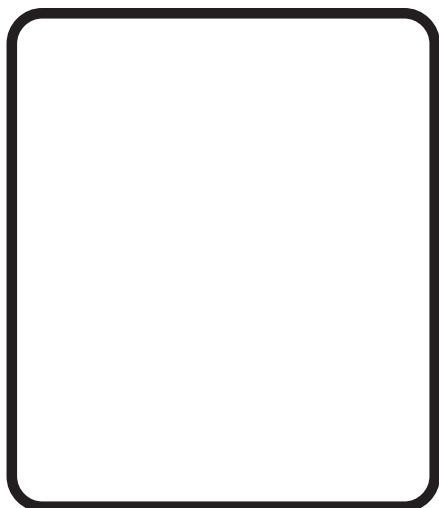

ULTRA-FINE SPACE-SAVER

FEATURING IN SERIES . . .

- SUCTION STRAINER
- PRE-FILTRATION
- SUB-MICRON PARTICLE RETENTION
- CARBON or RESIN PURIFICATION

Unique systems featuring complete interchangeability of filter media to achieve the ultimate in solution clarity at lowest possible cost . . . all with a minimum of effort, space and attention. Solution contact is all-plastic. High pressure pump provides economical use of filter media.

Standard system includes CPVC chambers with ethylene propylene "O"-rings and chemically resistant, seal-less, magnetic coupled, Ryton® pump with 1/2 HP TEFC, 3450 RPM, 115-230/1/60 motor. Hose is 3/4" vinyl reinforced. Consult factory for other sizes or materials of construction.

TO ORDER

MODEL	MAX. PSI	DIMENSIONS L x W x H		FILTER MEDIA * Inches	PRICE CODE NO.
		Inches	mm.		
CL10x3 3/4V MRGR	19	19 x 10 x 20	483 x 254 x 508	3-10	1632B
CL20x3 3/4V MRGR		x 30	x 762	3-20	1633B
CL30x3 3/4V MRGR		x 40	x 1016	3-30	1634B
CL40x3 3/4V MRGR		x 50	x 1270	3-40	1635B

* Filter media ordered separately

OPTIONAL

	ADD TO MODEL NO.	PRICE CODE NO.
Portable, with two wheels and front legs.	-P	191
To change CPVC filter chamber to ABS & Acrylic, change CL to AUL in Model No.	Add suffix "A" to Price Code No.	
222 "O" ring seat for SOE (single open end flat top cartridge)	-2	-2

PHOTO RESIST FILTRATION SYSTEMS

- **EXPLOSION-PROOF MOTOR**
The use of bonding and grounding cables in system are recommended to dissipate static electricity when pumping flammables and combustibles.
- **SELF-PRIMING PUMP**
- **REPLACEABLE DEPTH-TYPE OR CLEANABLE FILTER MEDIA** (*Ordered separately*)
- **LEAK-PROOF MECHANICAL SEAL**
- **OPTIONAL PUMP SPEED**

Reduce product rejects in chemical manufacturing. Use for recirculating process solutions. Sharpen product detail, eliminate pinholes, bubbles and reduce heat in volume production. Extend useful life of solutions.

Each system consists of one or two 316 stainless steel filter chambers as indicated, a long-coupled stainless steel self-priming gear pump with stainless steel gear, TFE sleeve bearing and Type #9 mechanical seal.

TO ORDER

MODEL	WEIGHT		PRICE CODE NO.
	Lbs.	Kg.	
With stainless steel single cartridge chamber.			
SS 10 3/8 ESS-G.5 (Exp.)	65	29	1098A
With stainless steel two-cartridge chamber			
SS 20 3/8 ESS-G.5 (Exp.)	75	34	1099A
With two stainless steel two-cartridge filter chambers.			
SS 20 x 2 3/8 ESS-G.5 (Exp.)	95	43	1100A

Registered trademark: Ryton - Phillips Chemical

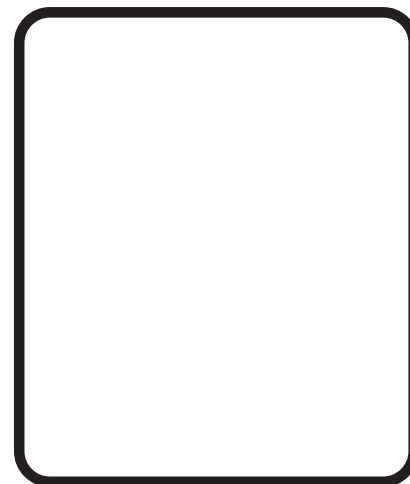

Belt driven by 1/2 H.P., 115/230/1/60, 1725 RPM, explosion-proof motor. Piping is stainless steel. Each system is mounted on a stainless steel enclosure 9" x 22" x 25" high. Systems provide 2.2 U.S. GPM flow and shut-off at 45 PSI.

OPTIONAL

DESCRIPTION	PRICE CODE NO.
Ground wire **	55-0246
Bond wire **	55-0245
Explosion-proof motor starter, not wired NEMA 7 Class I, Div. 2, Group C and D NEMA 9 Class II, Div. 2, Group E, F and G	66-0206

** The high velocity of material through a pump could create static electricity. All pumps and containers must be properly grounded and bonded to prevent static discharge and sparking, which could cause electric shock, fire or explosion.

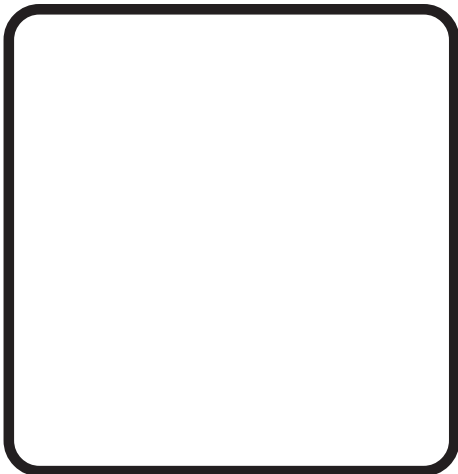

MICRO-FILTER FILTRATION SYSTEM

For small volumes of liquid, 1/2 pint to 2 gallons.

- SEAL-LESS SELF-PRIMING PERISTALTIC PUMP w/vinyl tube
- POLYCARBONATE FILTER CHAMBER w/Viton® "O"-ring
- 0.3, 1, 2 AND 8 MICRON FILTER ELEMENTS
- CPVC FITTINGS
- TO 8.5 U.S. GPH (32 LPH) OR 20 PSI (1.4 kg./cm²)
- 160°F (71°C) MAXIMUM TEMPERATURE

For recirculation and filtration of miniature and small plating cells used for the manufacture of micro-circuits and similar electronic components.

EXAMPLE: A 267 ml Hull cell would require 0.28 grams of powdered carbon to analyze the equivalent of 1.0 lbs. of carbon/100 gallons of plating

solution. The Micro-Filter with a 0.3 micron element will remove the powdered carbon from the Hull cell. The filter element provides 98% efficiency and is constructed of glass filled, resin impregnated microfibers. (Ordered separately).

Hull cell not provided.

TO ORDER

MODEL	TEFC MOTOR	DIMENSIONS	SHIPPING WEIGHT	PRICE CODE NUMBER
		L x W x H Inches (mm)	Lbs. (kg.)	
AUL3/16VRVH	1/15 H.P. 115V/1/60	8½ x 8½ x 11¼ (216 x 216 x 286)	13 (5.9)	0337

FILTER ELEMENTS	
MICRON	PRICE CODE NO.
0.3	99-0358
1.0	99-0357
2.0	99-0356
8.0	99-0355

Hose is 3/16" I.D. clear vinyl, 3 ft. suction and discharge.
Base is vinyl coated steel, 8" x 6" x 1½" (203mm x 152mm x 38mm).

Viton is a registered trademark of DuPont.

COUNTER-TOP FILTRATION SYSTEM

- ADJUSTABLE FLOW RATE TO ZERO
Maximum - 2.25 U.S. GPM (8.5 LPM)
- RECIRCULATE SMALL BATCHES
Minimum - 1/5 Qt. (1438 ml)
Maximum - 2.25 Qt. (2129 ml)
- SUB-MICRON PARTICLE RETENTION
- CARTRIDGE: DEPTH, CARBON, SLEEVE

Both clarification and purification may be accomplished through the use of various filter media offering particle retention down to sub-micron sizes. Cleanable sleeves may be precoated with filter aid and carbon when purification is required.

This filtration system is a self-contained unit, consisting of liquid holding chamber and filter chamber constructed of ABS and acrylic with ethylene propylene "O"-ring. Leakproof operation, with 1/12 H.P., TEFC, 3000 RPM, 115/1/50-60 motor and flow control valve. All mounted on a compact 6"x 6" (152mm x 152mm) vinyl covered base. Hose is 1/2" vinyl reinforced.

For use with Hull Cell (not provided)

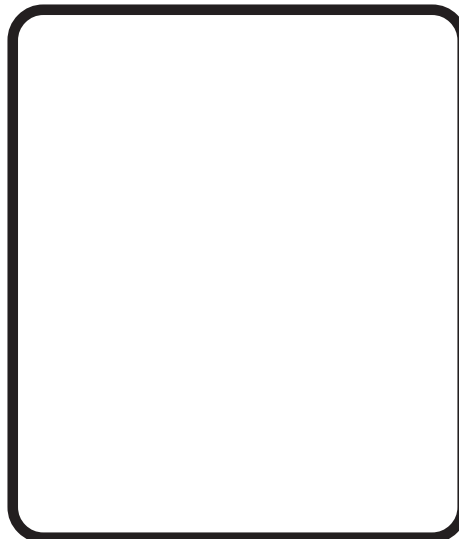

TO ORDER

MODEL	FILT. CART. LENGTH	PRICE CODE NO.
AU6xAUL6 1/2V APS	6"	0335
AU6xAUL10 1/2V APS	10"	0419
AU6xAUL20 1/2V APS	20"	0420
AU6xAUL30 1/2V APS	30"	0421

Filter cartridge ordered separately.

STAINLESS STEEL FILTRATION SYSTEMS

ASSEMBLED TO YOUR SPECIFICATIONS
for Chemical, Pharmaceutical, Petroleum, Waste treatment

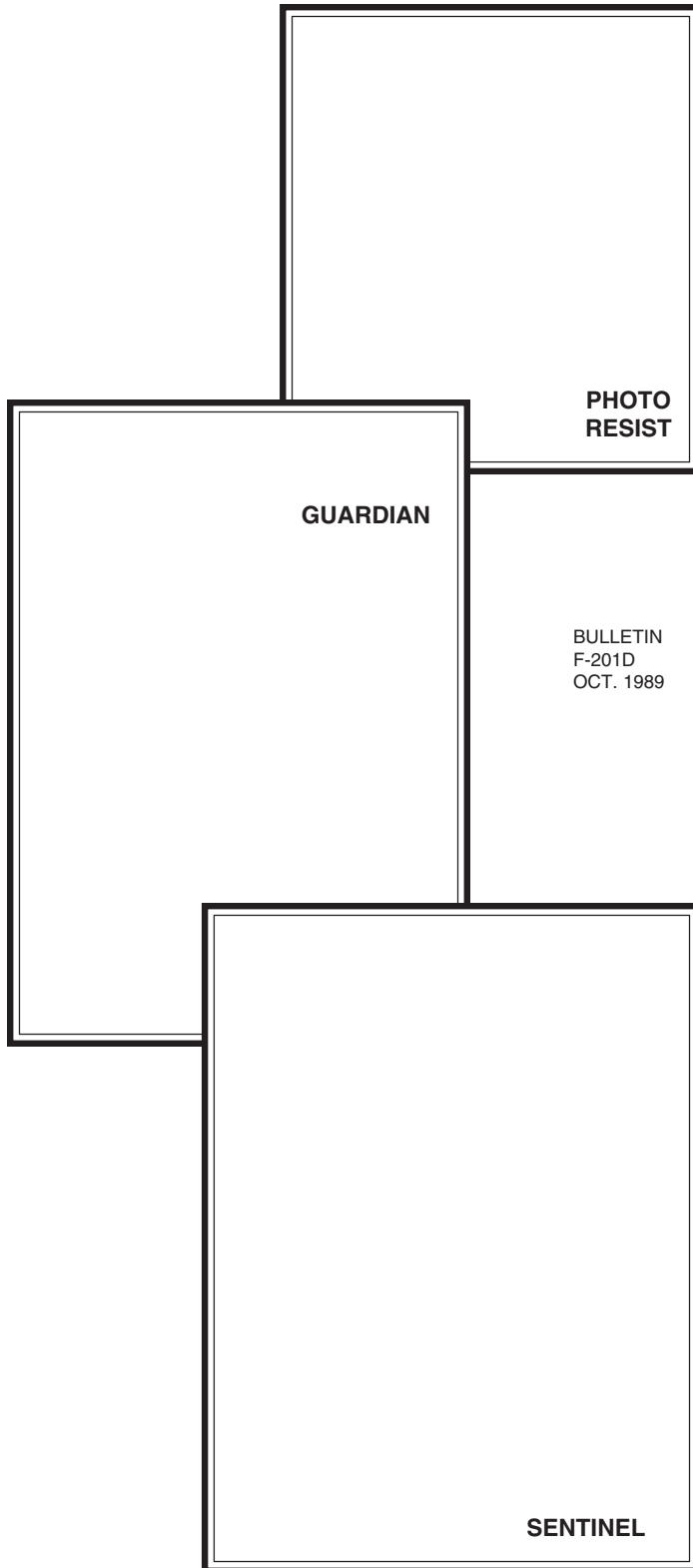

- 304 or 316 STAINLESS STEEL
- CHOICE of PUMPS
 - Gear or centrifugal, self-priming or end suction
 - Magnetic-coupled
Leakproof or mechanical sealed
- PORTABLE or STATIONARY
- CHOICE of MOTOR ENCLOSURES including open, totally enclosed, water-tight or explosion-proof
- FILTERS offering nominal coarse screens down to submicron absolute partial retention
- VALVING for either automatic or manual backwashing

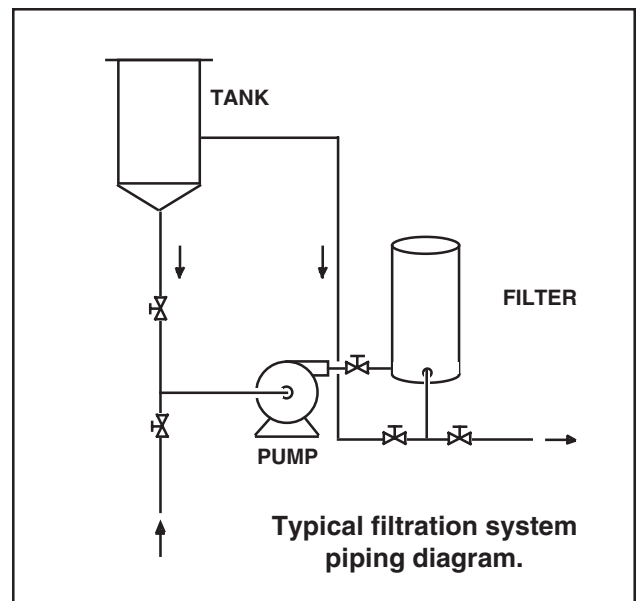

*Also available in carbon steel,
plastic or rubber lined.*