

SERIES 'DP' DRUM PUMP

PARTS LIST
P-1020G
FEB. 2003

OPEN DRIP PROOF AND TOTALLY ENCLOSED MOTORS FOR DRUM PUMPS

WARNING: Motor should not be used to pump flammables.

ODP-S	ENC-S
52-8000 115V	52-3000 115V
52-8001 230V	52-3001 230V

Refer to Bulletin P-402, Operation and Service Guide O-176 and Master Price List F-800.

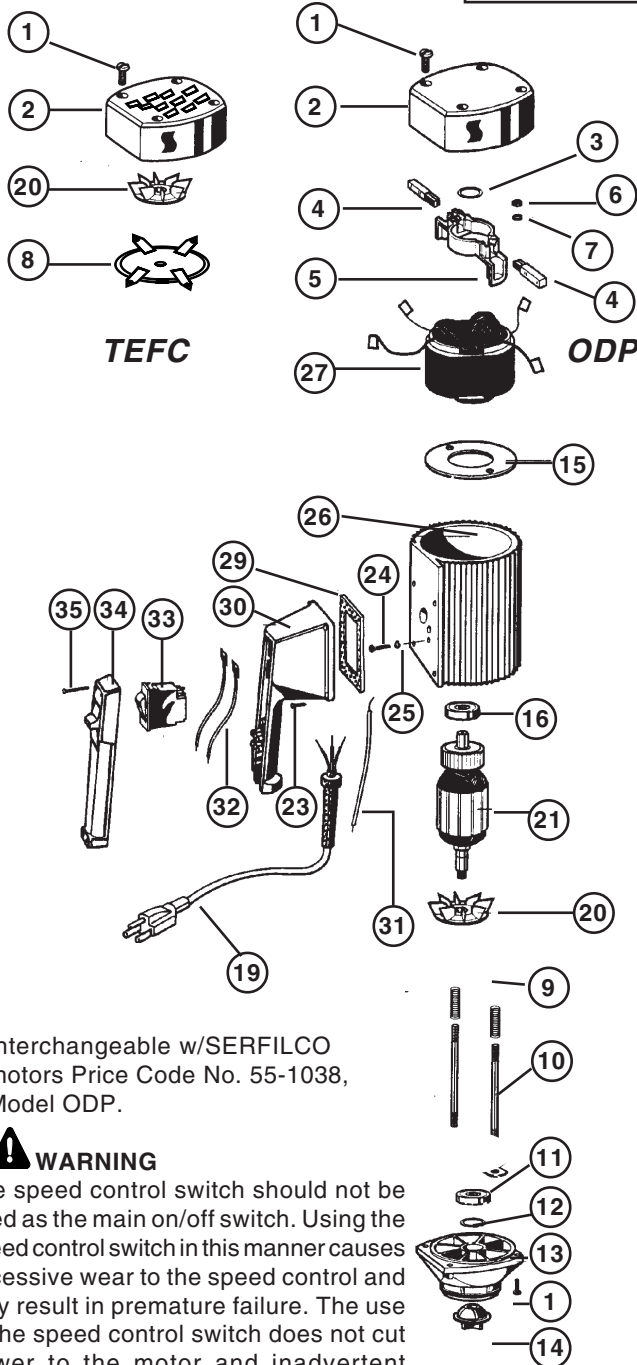

* Interchangeable w/SERFILCO motors Price Code No. 55-1038, Model ODP.

** ⚠ WARNING

The speed control switch should not be used as the main on/off switch. Using the speed control switch in this manner causes excessive wear to the speed control and may result in premature failure. The use of the speed control switch does not cut power to the motor and inadvertent activation could result in injury or death if the motor is activated when not properly attended and secured.

Terms: Net 30 Days
Minimum order \$25.00

F.O.B. Northbrook, Illinois

ITEM	DESCRIPTION	PART NUMBER	
		ODP	ENC
1*	Screw (8 req'd)	52-8130 1	52-3130
2*	Motor cover	52-8123	52-3123
3*	Wave washer	52-8125	
4	Carbon brush (2 req'd) - 115V - 230V	52-8509 52-8703	
5	Brush holder	52-8508	
6*	Hexagon nut (2 req'd)	52-8448	
7	Lockwasher (2 req'd)	52-8071	
8	End shield	-	52-3511
9	Pressure spring (2 req'd)	52-8507	-
10	Rod connector (2 req'd)	52-8506	
11*	Ball bearing, sealed	52-8126	
12*	Snap ring	52-8134	
13*	Lower housing	52-8100	
14*	Motor coupling	52-8333	
15	Guide disc	52-8504	52-3504
16*	Ball bearing, sealed	52-8331	
19*	Power cord w/strain relief - 115V - 230V	52-8360 52-8705	
20	Fan	52-8501	52-3501
21	Armature - 115V - 230V	52-8502 52-8701	52-3502 52-3701
23*	Screw (4 req'd)	52-8131	
24*	Screw	52-8162	
25*	Lock washer	52-8071	
26	Motor housing - 115V - 230V	52-8510	52-3510 52-3510 2
27	Stator - 115V - 230V	52-8503 52-8702	52-3503 52-3702
29*	Gasket Gasket for switch w/Low Volt. Release	52-8167 52-8167L	
30*	Switch housing	52-3124	
31*	Grounding lead	52-8183	
32*	Lead	52-8185	
33*	Switch - 115V - 230V Switch w/Low Voltage Release - 230V	52-8611 52-8704 52-8704L	
34*	Switch cover	52-8002	
35*	Screw (4 req'd)	52-8220	
36** (not shown)	Speed control, potentiometer ass'y - 115V - 230V	52-9800 H 52-9801 H	
37 (not shown)	Motor housing sleeve for 230V TEFC only	52-3503 1NS	

SERFILCO®, LTD.

2900 MacArthur Blvd. 847-559-1777
Northbrook, IL 60062-2005 U.S.A. 800-323-5431
e-mail: sales@serfilco.com FAX: 847-559-1995
www.serfilco.com

WESTERN
310-532-0801
FAX: 310-532-0866